

# FORTFIELD ROAD, D6W

## VERIFIED VIEWS & VISUALIZATION

07.11.2024

URBAN -  
AGENCY





# CONTENTS

---

- 01 VERIFIED VIEWS
- 02 VISUALIZATION



# 01. VERIFIED VIEWS

## 01.1 MAP

**NOTE:**  
This document is for discussion purpose only. All figures shown are an approximate estimation and are subject to further design development, accurate site survey and services (drainages, ESB, gas, etc.) and potential existing site restrictions (flooding, trees preservation, traffic, fire etc.). Please note also that any proposed concept layout in this document is subject to full planning permission being granted.



**MODEL  
WORKS**

project: Fortfield Road

viewpoint: **View Location Map**

issued: 09/02/2024



01. VERIFIED VIEWS

VIEW 01 - EXISTING

**NOTE:**  
This document is for discussion purpose only. All figures shown are an approximate estimation and are subject to further design development, accurate site survey and services (drainages, ESB, gas, etc.) and potential existing site restrictions (flooding, trees preservation, traffic, fire etc.). Please note also that any proposed concept layout in this document is subject to full planning permission being granted.



◀◀ Angle of View 73° Horizontal ( 24 mm Lens )      ◀ Angle of View 39° Horizontal ( 50 mm Lens )      ▶▶

<b>MODEL WORKS</b>	<i>project:</i> Fortfield Road	<i>photography:</i> 09-02-2022 14:06 Canon 5D Mark II 24 mm Lens	<i>location:</i>  E 313250.241 N 229933.280	<i>viewpoint:</i> <b>View 1 Existing</b>
				<i>issued:</i> 09-02-2024



01. VERIFIED VIEWS

VIEW 01 - PROPOSED

**NOTE:**  
This document is for discussion purpose only. All figures shown are an approximate estimation and are subject to further design development, accurate site survey and services (drainages, ESB, gas, etc.) and potential existing site restrictions (flooding, trees preservation, traffic, fire etc.). Please note also that any proposed concept layout in this document is subject to full planning permission being granted.



◀◀ Angle of View 73° Horizontal ( 24 mm Lens )      ◀ Angle of View 39° Horizontal ( 50 mm Lens )      ▶▶

<b>MODEL WORKS</b>	project: Fortfield Road	photography: 09-02-2022 14:06 Canon 5D Mark II 24 mm Lens	location: E 313250.241 N 229933.280	viewpoint: <b>View 1</b> <b>Proposed</b>
				issued: 09-02-2024



01. VERIFIED VIEWS

VIEW 02 - EXISTING

**NOTE:**  
This document is for discussion purpose only. All figures shown are an approximate estimation and are subject to further design development, accurate site survey and services (drainages, ESB, gas, etc.) and potential existing site restrictions (flooding, trees preservation, traffic, fire etc.). Please note also that any proposed concept layout in this document is subject to full planning permission being granted.



◀◀ Angle of View 73° Horizontal ( 24 mm Lens )      ◀ Angle of View 39° Horizontal ( 50 mm Lens )      ▶▶

<b>MODEL WORKS</b>	project: Fortfield Road	photography: 09-02-2022 14:24 Canon 5D Mark II 24 mm Lens	location: E 313402.627 N 229937.518	viewpoint: <b>View 2 Existing</b>
				issued: 09-02-2024



01. VERIFIED VIEWS

VIEW 02 - PROPOSED

**NOTE:**  
This document is for discussion purpose only. All figures shown are an approximate estimation and are subject to further design development, accurate site survey and services (drainages, ESB, gas, etc.) and potential existing site restrictions (flooding, trees preservation, traffic, fire etc.). Please note also that any proposed concept layout in this document is subject to full planning permission being granted.



◀◀ Angle of View 73° Horizontal ( 24 mm Lens )      ◀◀ Angle of View 39° Horizontal ( 50 mm Lens )      ▶▶ ▶▶

<b>MODEL WORKS</b>	project: Fortfield Road	photography: 09-02-2022 14:24 Canon 5D Mark II 24 mm Lens	location: E 313402.627 N 229937.518	viewpoint: <b>View 2 Proposed</b>
				issued: 09-02-2024



01. VERIFIED VIEWS

VIEW 03 - EXISTING

**NOTE:**  
This document is for discussion purpose only. All figures shown are an approximate estimation and are subject to further design development, accurate site survey and services (drainages, ESB, gas, etc.) and potential existing site restrictions (flooding, trees preservation, traffic, fire etc.). Please note also that any proposed concept layout in this document is subject to full planning permission being granted.



◀◀ Angle of View 73° Horizontal ( 24 mm Lens )      ◀◀ Angle of View 39° Horizontal ( 50 mm Lens )      ▶▶ ▶▶

<b>MODEL WORKS</b>	<i>project:</i> Fortfield Road	<i>photography:</i> 09-02-2022 09:41 Canon 5D Mark II 24 mm Lens	<i>location:</i>  E 313803.328 N 230100.253	<i>viewpoint:</i> <b>View 3 Existing</b>
				<i>issued:</i> 09-02-2024



01. VERIFIED VIEWS

VIEW 03 - PROPOSED

**NOTE:**  
This document is for discussion purpose only. All figures shown are an approximate estimation and are subject to further design development, accurate site survey and services (drainages, ESB, gas, etc.) and potential existing site restrictions (flooding, trees preservation, traffic, fire etc.). Please note also that any proposed concept layout in this document is subject to full planning permission being granted.



Angle of View 73° Horizontal ( 24 mm Lens )      Angle of View 39° Horizontal ( 50 mm Lens )

<b>MODEL WORKS</b>	<i>project:</i> Fortfield Road	<i>photography:</i> 09-02-2022 09:41 Canon 5D Mark II 24 mm Lens	<i>location:</i>  E 313803.328 N 230100.253	<i>viewpoint:</i> <b>View 3</b> <b>Proposed</b>
				<i>issued:</i> 09-02-2024



01. VERIFIED VIEWS

VIEW 04 - EXISTING

**NOTE:**  
This document is for discussion purpose only. All figures shown are an approximate estimation and are subject to further design development, accurate site survey and services (drainages, ESB, gas, etc.) and potential existing site restrictions (flooding, trees preservation, traffic, fire etc.). Please note also that any proposed concept layout in this document is subject to full planning permission being granted.



◀◀ Angle of View 73° Horizontal ( 24 mm Lens )      ◀ Angle of View 39° Horizontal ( 50 mm Lens )      ▶▶

<b>MODEL WORKS</b>	<i>project:</i> Fortfield Road	<i>photography:</i> 09-02-2022 10:00 Canon 5D Mark II 24 mm Lens	<i>location:</i>  E 313889.418 N 229830.474	<i>viewpoint:</i> <b>View 4 Existing</b>
				<i>issued:</i> 09-02-2024



01. VERIFIED VIEWS

VIEW 04 - PROPOSED

**NOTE:**  
This document is for discussion purpose only. All figures shown are an approximate estimation and are subject to further design development, accurate site survey and services (drainages, ESB, gas, etc.) and potential existing site restrictions (flooding, trees preservation, traffic, fire etc.). Please note also that any proposed concept layout in this document is subject to full planning permission being granted.



◀◀ Angle of View 73° Horizontal ( 24 mm Lens )      ◀◀ Angle of View 39° Horizontal ( 50 mm Lens )      ▶▶ ▶▶

<b>MODEL WORKS</b>	project: Fortfield Road	photography: 09-02-2022 10:00 Canon 5D Mark II 24 mm Lens	location: E 313889.418 N 229830.474	viewpoint: <b>View 4</b> <b>Proposed</b>
				issued: 09-02-2024



01. VERIFIED VIEWS

VIEW 05 - EXISTING

**NOTE:**  
This document is for discussion purpose only. All figures shown are an approximate estimation and are subject to further design development, accurate site survey and services (drainages, ESB, gas, etc.) and potential existing site restrictions (flooding, trees preservation, traffic, fire etc.). Please note also that any proposed concept layout in this document is subject to full planning permission being granted.



◀◀ Angle of View 73° Horizontal ( 24 mm Lens )      ◀ Angle of View 39° Horizontal ( 50 mm Lens )      ▶▶

<b>MODEL WORKS</b>	<i>project:</i> Fortfield Road	<i>photography:</i> 09-02-2022 10:23 Canon 5D Mark II 24 mm Lens	<i>location:</i>  E 313739.711 N 229838.512	<i>viewpoint:</i> <b>View 5 Existing</b>
				<i>issued:</i> 09-02-2024



01. VERIFIED VIEWS

VIEW 05 - PROPOSED

**NOTE:**  
This document is for discussion purpose only. All figures shown are an approximate estimation and are subject to further design development, accurate site survey and services (drainages, ESB, gas, etc.) and potential existing site restrictions (flooding, trees preservation, traffic, fire etc.). Please note also that any proposed concept layout in this document is subject to full planning permission being granted.



Angle of View 73° Horizontal ( 24 mm Lens )      Angle of View 39° Horizontal ( 50 mm Lens )

<b>MODEL WORKS</b>	<i>project:</i> Fortfield Road	<i>photography:</i> 09-02-2022 10:23 Canon 5D Mark II 24 mm Lens	<i>location:</i>  E 313739.711 N 229838.512	<i>viewpoint:</i> <b>View 5</b> <b>Proposed</b>
				<i>issued:</i> 09-02-2024



01. VERIFIED VIEWS

VIEW 06 - EXISTING

**NOTE:**  
This document is for discussion purpose only. All figures shown are an approximate estimation and are subject to further design development, accurate site survey and services (drainages, ESB, gas, etc.) and potential existing site restrictions (flooding, trees preservation, traffic, fire etc.). Please note also that any proposed concept layout in this document is subject to full planning permission being granted.



◀◀ Angle of View 73° Horizontal ( 24 mm Lens )      ◀ Angle of View 39° Horizontal ( 50 mm Lens )      ▶▶

<b>MODEL WORKS</b>	<i>project:</i> Fortfield Road	<i>photography:</i> 09-02-2022 10:51 Canon 5D Mark II 24 mm Lens	<i>location:</i>  E 313812.835 N 229496.769	<i>viewpoint:</i> <b>View 6 Existing</b>
				<i>issued:</i> 09-02-2024



01. VERIFIED VIEWS

VIEW 06 - PROPOSED

**NOTE:**  
This document is for discussion purpose only. All figures shown are an approximate estimation and are subject to further design development, accurate site survey and services (drainages, ESB, gas, etc.) and potential existing site restrictions (flooding, trees preservation, traffic, fire etc.). Please note also that any proposed concept layout in this document is subject to full planning permission being granted.



Angle of View 73° Horizontal ( 24 mm Lens )      Angle of View 39° Horizontal ( 50 mm Lens )

<b>MODEL WORKS</b>	project: Fortfield Road	photography: 09-02-2022 10:51 Canon 5D Mark II 24 mm Lens	location:  E 313812.835 N 229496.769	viewpoint: <b>View 6</b> <b>Proposed</b>
				issued: 09-02-2024



01. VERIFIED VIEWS

VIEW 07 - EXISTING

**NOTE:**  
This document is for discussion purpose only. All figures shown are an approximate estimation and are subject to further design development, accurate site survey and services (drainages, ESB, gas, etc.) and potential existing site restrictions (flooding, trees preservation, traffic, fire etc.). Please note also that any proposed concept layout in this document is subject to full planning permission being granted.



◀◀ Angle of View 73° Horizontal ( 24 mm Lens )      ◀ Angle of View 39° Horizontal ( 50 mm Lens )      ▶▶

<b>MODEL WORKS</b>	project: Fortfield Road	photography: 09-02-2022 11:16 Canon 5D Mark II 24 mm Lens	location: E 313571.398 N 229261.549	viewpoint: <b>View 7 Existing</b>
				issued: 09-02-2024



01. VERIFIED VIEWS

VIEW 07 - PROPOSED

**NOTE:**  
This document is for discussion purpose only. All figures shown are an approximate estimation and are subject to further design development, accurate site survey and services (drainages, ESB, gas, etc.) and potential existing site restrictions (flooding, trees preservation, traffic, fire etc.). Please note also that any proposed concept layout in this document is subject to full planning permission being granted.



Angle of View 73° Horizontal ( 24 mm Lens )      Angle of View 39° Horizontal ( 50 mm Lens )

<b>MODEL WORKS</b>	project: Fortfield Road	photography: 09-02-2022 11:16 Canon 5D Mark II 24 mm Lens	location: E 313571.398 N 229261.549	viewpoint: <b>View 7</b> <b>Proposed</b>
				issued: 09-02-2024



01. VERIFIED VIEWS

VIEW 08 - EXISTING

**NOTE:**  
This document is for discussion purpose only. All figures shown are an approximate estimation and are subject to further design development, accurate site survey and services (drainages, ESB, gas, etc.) and potential existing site restrictions (flooding, trees preservation, traffic, fire etc.). Please note also that any proposed concept layout in this document is subject to full planning permission being granted.



Angle of View 73° Horizontal ( 24 mm Lens )      Angle of View 39° Horizontal ( 50 mm Lens )

<b>MODEL WORKS</b>	<i>project:</i> Fortfield Road	<i>photography:</i> 09-02-2022 11:29 Canon 5D Mark II 24 mm Lens	<i>location:</i>  E 313409.196 N 229508.473	<i>viewpoint:</i> <b>View 8 Existing</b>
				<i>issued:</i> 09-02-2024



01. VERIFIED VIEWS

VIEW 08 - PROPOSED

**NOTE:**  
This document is for discussion purpose only. All figures shown are an approximate estimation and are subject to further design development, accurate site survey and services (drainages, ESB, gas, etc.) and potential existing site restrictions (flooding, trees preservation, traffic, fire etc.). Please note also that any proposed concept layout in this document is subject to full planning permission being granted.



◀◀ Angle of View 73° Horizontal ( 24 mm Lens )      ◀ Angle of View 39° Horizontal ( 50 mm Lens )      ▶▶

<b>MODEL WORKS</b>	<i>project:</i> Fortfield Road	<i>photography:</i> 09-02-2022 11:29 Canon 5D Mark II 24 mm Lens	<i>location:</i>  E 313409.196 N 229508.473	<i>viewpoint:</i> <b>View 8</b> <b>Proposed</b>
				<i>issued:</i> 09-02-2024



01. VERIFIED VIEWS

VIEW 09 - EXISTING

**NOTE:**  
This document is for discussion purpose only. All figures shown are an approximate estimation and are subject to further design development, accurate site survey and services (drainages, ESB, gas, etc.) and potential existing site restrictions (flooding, trees preservation, traffic, fire etc.). Please note also that any proposed concept layout in this document is subject to full planning permission being granted.



◀◀ Angle of View 73° Horizontal ( 24 mm Lens )      ◀ Angle of View 39° Horizontal ( 50 mm Lens )      ▶▶

<b>MODEL WORKS</b>	<i>project:</i> Fortfield Road	<i>photography:</i> 09-02-2022 11:52 Canon 5D Mark II 24 mm Lens	<i>location:</i>  E 313233.471 N 229562.285	<i>viewpoint:</i> <b>View 9 Existing</b>
				<i>issued:</i> 09-02-2024



01. VERIFIED VIEWS

VIEW 09 - PROPOSED

**NOTE:**  
This document is for discussion purpose only. All figures shown are an approximate estimation and are subject to further design development, accurate site survey and services (drainages, ESB, gas, etc.) and potential existing site restrictions (flooding, trees preservation, traffic, fire etc.). Please note also that any proposed concept layout in this document is subject to full planning permission being granted.



Angle of View 73° Horizontal ( 24 mm Lens )      Angle of View 39° Horizontal ( 50 mm Lens )

<b>MODEL WORKS</b>	<i>project:</i> Fortfield Road	<i>photography:</i> 09-02-2022 11:52 Canon 5D Mark II 24 mm Lens	<i>location:</i>  E 313233.471 N 229562.285	<i>viewpoint:</i> <b>View 9</b> <b>Proposed</b>
				<i>issued:</i> 09-02-2024



01. VERIFIED VIEWS

VIEW 10 - EXISTING

**NOTE:**  
This document is for discussion purpose only. All figures shown are an approximate estimation and are subject to further design development, accurate site survey and services (drainages, ESB, gas, etc.) and potential existing site restrictions (flooding, trees preservation, traffic, fire etc.). Please note also that any proposed concept layout in this document is subject to full planning permission being granted.



◀◀ Angle of View 73° Horizontal ( 24 mm Lens )      ◀ Angle of View 39° Horizontal ( 50 mm Lens )      ▶▶

<b>MODEL WORKS</b>	project: Fortfield Road	photography: 09-02-2022 13:41 Canon 5D Mark II 24 mm Lens	location: E 313070.828 N 229701.773	viewpoint: <b>View 10 Existing</b>
				issued: 09-02-2024



01. VERIFIED VIEWS

VIEW 10 - PROPOSED

**NOTE:**  
This document is for discussion purpose only. All figures shown are an approximate estimation and are subject to further design development, accurate site survey and services (drainages, ESB, gas, etc.) and potential existing site restrictions (flooding, trees preservation, traffic, fire etc.). Please note also that any proposed concept layout in this document is subject to full planning permission being granted.



◀◀ Angle of View 73° Horizontal ( 24 mm Lens )      ◀ Angle of View 39° Horizontal ( 50 mm Lens )      ▶▶

<b>MODEL WORKS</b>	<i>project:</i> Fortfield Road	<i>photography:</i> 09-02-2022 13:41 Canon 5D Mark II 24 mm Lens	<i>location:</i>  E 313070.828 N 229701.773	<i>viewpoint:</i> <b>View 10 Proposed</b>
				<i>issued:</i> 09-02-2024



01. VERIFIED VIEWS

VIEW 11 - EXISTING

**NOTE:**  
This document is for discussion purpose only. All figures shown are an approximate estimation and are subject to further design development, accurate site survey and services (drainages, ESB, gas, etc.) and potential existing site restrictions (flooding, trees preservation, traffic, fire etc.). Please note also that any proposed concept layout in this document is subject to full planning permission being granted.



Angle of View 73° Horizontal ( 24 mm Lens )      Angle of View 39° Horizontal ( 50 mm Lens )

<b>MODEL WORKS</b>	<i>project:</i> Fortfield Road	<i>photography:</i> 15-07-2024 12:25 Canon 5D Mark II 24 mm Lens	<i>location:</i>  E 313687.500 N 229649.331	<i>viewpoint:</i> <b>View 11 Existing</b>
				<i>issued:</i> 16/07/2024



01. VERIFIED VIEWS

VIEW 11 - PROPOSED

**NOTE:**  
This document is for discussion purpose only. All figures shown are an approximate estimation and are subject to further design development, accurate site survey and services (drainages, ESB, gas, etc.) and potential existing site restrictions (flooding, trees preservation, traffic, fire etc.). Please note also that any proposed concept layout in this document is subject to full planning permission being granted.



Angle of View 73° Horizontal ( 24 mm Lens )      Angle of View 39° Horizontal ( 50 mm Lens )

<b>MODEL WORKS</b>	<i>project:</i> Fortfield Road	<i>photography:</i> 15-07-2024 12:25 Canon 5D Mark II 24 mm Lens	<i>location:</i>  E 313687.500 N 229649.331	<i>viewpoint:</i> <b>View 11 Proposed</b>
				<i>issued:</i> 16/07/2024



01. VERIFIED VIEWS

VIEW 12 - EXISTING

**NOTE:**  
This document is for discussion purpose only. All figures shown are an approximate estimation and are subject to further design development, accurate site survey and services (drainages, ESB, gas, etc.) and potential existing site restrictions (flooding, trees preservation, traffic, fire etc.). Please note also that any proposed concept layout in this document is subject to full planning permission being granted.



<b>MODEL WORKS</b>	<i>project:</i> Fortfield Road	<i>photography:</i> 15-07-2024 11:48 Canon 5D Mark II 24 mm Lens	<i>location:</i>	<i>viewpoint:</i> <b>View 12 Existing</b>
			E 313361.882 N 229685.036	<i>issued:</i> 16/07/2024



01. VERIFIED VIEWS

VIEW 12 - PROPOSED

**NOTE:**  
This document is for discussion purpose only. All figures shown are an approximate estimation and are subject to further design development, accurate site survey and services (drainages, ESB, gas, etc.) and potential existing site restrictions (flooding, trees preservation, traffic, fire etc.). Please note also that any proposed concept layout in this document is subject to full planning permission being granted.



Angle of View 73° Horizontal ( 24 mm Lens )      Angle of View 39° Horizontal ( 50 mm Lens )

<b>MODEL WORKS</b>	project: Fortfield Road	photography: 15-07-2024 11:48 Canon 5D Mark II 24 mm Lens	location:  E 313361.882 N 229685.036	viewpoint: <b>View 12 Proposed</b>
				issued: 16/07/2024



01. VERIFIED VIEWS

VIEW 13 - EXISTING

**NOTE:**  
This document is for discussion purpose only. All figures shown are an approximate estimation and are subject to further design development, accurate site survey and services (drainages, ESB, gas, etc.) and potential existing site restrictions (flooding, trees preservation, traffic, fire etc.). Please note also that any proposed concept layout in this document is subject to full planning permission being granted.



Angle of View 73° Horizontal ( 24 mm Lens )

Angle of View 39° Horizontal ( 50 mm Lens )

<b>MODEL WORKS</b>	project: Fortfield Road	photography: 15-07-2024 12:03 Canon 5D Mark II 24 mm Lens	location: E 313304.654 N 229789.299	viewpoint: <b>View 13 Existing</b>
				issued: 16/07/2024



01. VERIFIED VIEWS

VIEW 13 - PROPOSED

**NOTE:**  
This document is for discussion purpose only. All figures shown are an approximate estimation and are subject to further design development, accurate site survey and services (drainages, ESB, gas, etc.) and potential existing site restrictions (flooding, trees preservation, traffic, fire etc.). Please note also that any proposed concept layout in this document is subject to full planning permission being granted.



◀◀ Angle of View 73° Horizontal ( 24 mm Lens )      ◀ Angle of View 39° Horizontal ( 50 mm Lens )      ▶▶

<b>MODEL WORKS</b>	<i>project:</i> Fortfield Road	<i>photography:</i> 15-07-2024 12:03 Canon 5D Mark II 24 mm Lens	<i>location:</i>  E 313304.654 N 229789.299	<i>viewpoint:</i> <b>View 13 Proposed</b>
				<i>issued:</i> 16/07/2024



# 02. VISUALIZATION

VIEW 14

**NOTE:**  
This document is for discussion purpose only. All figures shown are an approximate estimation and are subject to further design development, accurate site survey and services (drainages, ESB, gas, etc.) and potential existing site restrictions (flooding, trees preservation, traffic, fire etc.). Please note also that any proposed concept layout in this document is subject to full planning permission being granted.





# 02. VISUALIZATION

VIEW 15

**NOTE:**  
This document is for discussion purpose only. All figures shown are an approximate estimation and are subject to further design development, accurate site survey and services (drainages, ESB, gas, etc.) and potential existing site restrictions (flooding, trees preservation, traffic, fire etc.). Please note also that any proposed concept layout in this document is subject to full planning permission being granted.





02. VISUALIZATION

VIEW 16

**NOTE:**  
This document is for discussion purpose only. All figures shown are an approximate estimation and are subject to further design development, accurate site survey and services (drainages, ESB, gas, etc.) and potential existing site restrictions (flooding, trees preservation, traffic, fire etc.). Please note also that any proposed concept layout in this document is subject to full planning permission being granted.





# 02. VISUALIZATION

VIEW 17

**NOTE:**  
This document is for discussion purpose only. All figures shown are an approximate estimation and are subject to further design development, accurate site survey and services (drainages, ESB, gas, etc.) and potential existing site restrictions (flooding, trees preservation, traffic, fire etc.). Please note also that any proposed concept layout in this document is subject to full planning permission being granted.





02. VISUALIZATION

VIEW 18

**NOTE:**  
This document is for discussion purpose only. All figures shown are an approximate estimation and are subject to further design development, accurate site survey and services (drainages, ESB, gas, etc.) and potential existing site restrictions (flooding, trees preservation, traffic, fire etc.). Please note also that any proposed concept layout in this document is subject to full planning permission being granted.





# 02. VISUALIZATION

VIEW 19

**NOTE:**  
This document is for discussion purpose only. All figures shown are an approximate estimation and are subject to further design development, accurate site survey and services (drainages, ESB, gas, etc.) and potential existing site restrictions (flooding, trees preservation, traffic, fire etc.). Please note also that any proposed concept layout in this document is subject to full planning permission being granted.





02. VISUALIZATION

VIEW 20

**NOTE:**  
This document is for discussion purpose only. All figures shown are an approximate estimation and are subject to further design development, accurate site survey and services (drainages, ESB, gas, etc.) and potential existing site restrictions (flooding, trees preservation, traffic, fire etc.). Please note also that any proposed concept layout in this document is subject to full planning permission being granted.

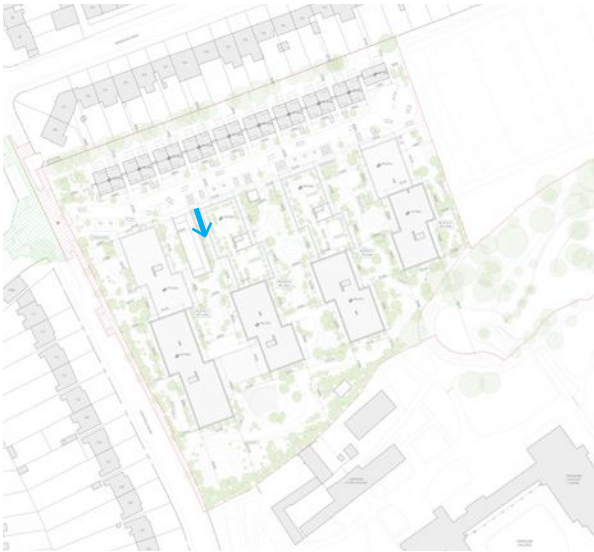



# 02. VISUALIZATION

VIEW 21

**NOTE:**  
This document is for discussion purpose only. All figures shown are an approximate estimation and are subject to further design development, accurate site survey and services (drainages, ESB, gas, etc.) and potential existing site restrictions (flooding, trees preservation, traffic, fire etc.). Please note also that any proposed concept layout in this document is subject to full planning permission being granted.

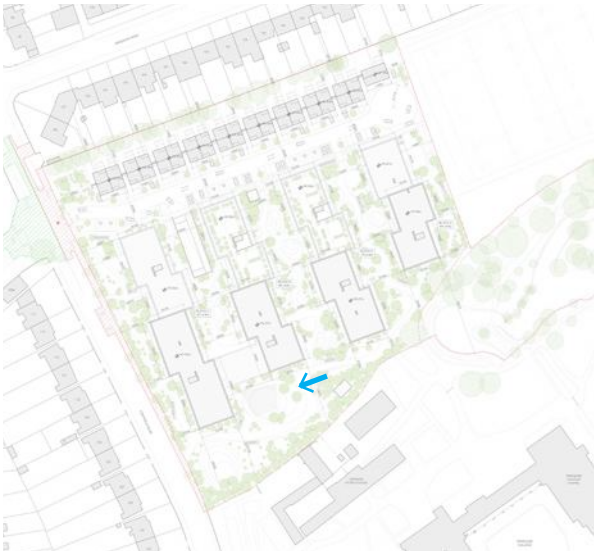



02. VISUALIZATION

VIEW 22

**NOTE:**  
This document is for discussion purpose only. All figures shown are an approximate estimation and are subject to further design development, accurate site survey and services (drainages, ESB, gas, etc.) and potential existing site restrictions (flooding, trees preservation, traffic, fire etc.). Please note also that any proposed concept layout in this document is subject to full planning permission being granted.





**DUBLIN**

1 Whitaker Court,  
Sir John Rogerson's Quay  
Dublin 2, Ireland  
+353 1 672 5907

**COPENHAGEN**

Kirsten Walthers Vej 9,  
2500 Valby,  
Copenhagen  
+45 3324 5420

**LYON**

14 Avenue Marc,  
Sangier,  
69100 Lyon  
+33 9 70 40 71 76

**NOTE:**

This document is for discussion purpose only. All figures shown are an approximate estimation and are subject to further design development, accurate site survey and services (drainages, ESB, gas, etc.) and potential existing site restrictions (flooding, trees preservation, traffic, fire etc.). Please note also that any proposed concept layout in this document is subject to full planning permission being granted.

**DUBLIN@URBAN-AGENCY.COM**

**WWW.URBAN-AGENCY.COM**